

Navigation Lights

Series 25 Standard

Robust navigation light with polycarbonate housing



Application

Application depending on required visibilities and vessel size. See table in chapter Information.

Housing

Polycarbonate, impact and shock resistant, non-corrosive, non-magnetic, seawater resistant

Optics

Lens: Fresnel, range of visibility 2 nm (starboard, port and bicolor 1 nm). Material: plastic, impact and shock-proof, seawater resistant

Protection degree

IP45

Mounting

Side-mount or deck-mount

Light source

Festoon, 10 W included

Remark

Certification Applicability
Aqua Signal navigation lights are certified as a complete assembly including the original equipment bulb. Use only certified OEM replacement bulbs to maintain ongoing certification.

Side-mount

Starboard / Port

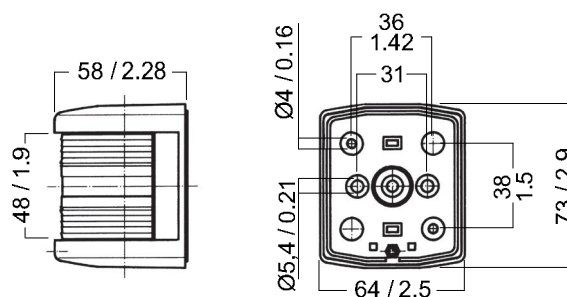

Dimensions in: mm / inch

	Description	Vessel size	Wattage	Visibility	Mounting	Voltage	Housing colour	Art. no.
	Starboard	< 12 m / < 39 ft.	10 W	1 nm	Side-mount	12 V	Black White	3519102000 3519112000
	Port	< 12 m / < 39 ft.	10 W	1 nm	Side-mount	12 V	Black White	3520202000 3520212000

Side-mount

Bicolor / Masthead / Stern

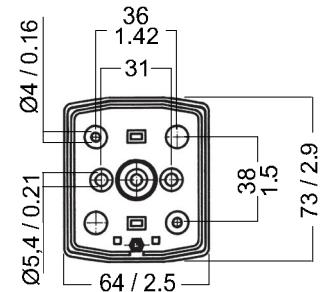
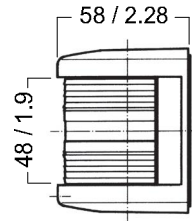

Dimensions in: mm / inch

	Description	Vessel size	Wattage	Visibility	Mounting	Voltage	Housing colour	Art. no.
	Bicolor	< 12 m / < 39 ft.	10 W	1 nm	Side-mount	12 V	Black	3518302000
							White	3518312000
	Masthead	< 12 m / < 39 ft.	10 W	2 nm	Side-mount	12 V	Black	3516002000
							White	3516012000
	Stern	< 50 m / < 164 ft.	10 W	2 nm	Side-mount	12 V	Black	3517702000
							White	3517712000

Deck-mount

All-round

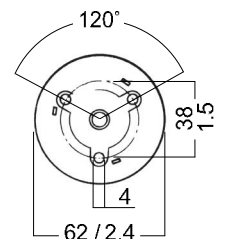
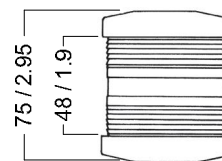

Dimensions in: mm / inch

	Description	Vessel size	Wattage	Visibility	Mounting	Voltage	Housing colour	Art. no.
	All-round white	< 50 m / < 164 ft.	10 W	2 nm	Deck-mount	12 V	Black	3513012000
							White	3513096000
	All-round red	< 50 m / < 164 ft.	21 W	2 nm	Deck-mount	12 V	Black	3513222000
	All-round green	< 50 m / < 164 ft.	21 W	2 nm	Deck-mount	12 V	Black	3513122000