

Turbine Series - 900FH/1000FH

FUEL

Specifications:

Height: 900FH: 16.5" (41.9 cm)
1000FH: 21.8" (55.4 cm)

Width: 5.96" (15.1 cm)

Depth: 5.96" (15.1 cm)
with Bracket 6.32" (16.1 cm)

Weight: 900FH: 6.0 lbs (2.7 kg)
1000FH: 10 lbs (4.5 kg)

Ports: 7/8"-14 UNF-2B (SAE J1926)

Service Clearance (Top): 900FH: 5.0" (12.7 cm)
1000FH: 10.0" (25.4 cm)

Vacuum Installation Recommended
Maximum Pressure: 15 psi (1.03 bar)

Max Flow Rate: 900FH: 90 gph (341 lph)
1000FH: 180 gph (681 lph)

Create a Part Number

Housing Type		Heater Option		Filtration Rating		
Turbine Model 90 GPH Flow Rate	Turbine Model 180 GPH Flow Rate	12 VDC Heater (325 watt)	24 VDC Heater (325 watt)	2 micron	10 micron	30 micron
900FH	1000FH	312	324	2	10	30

RACOR®

Dimensions:

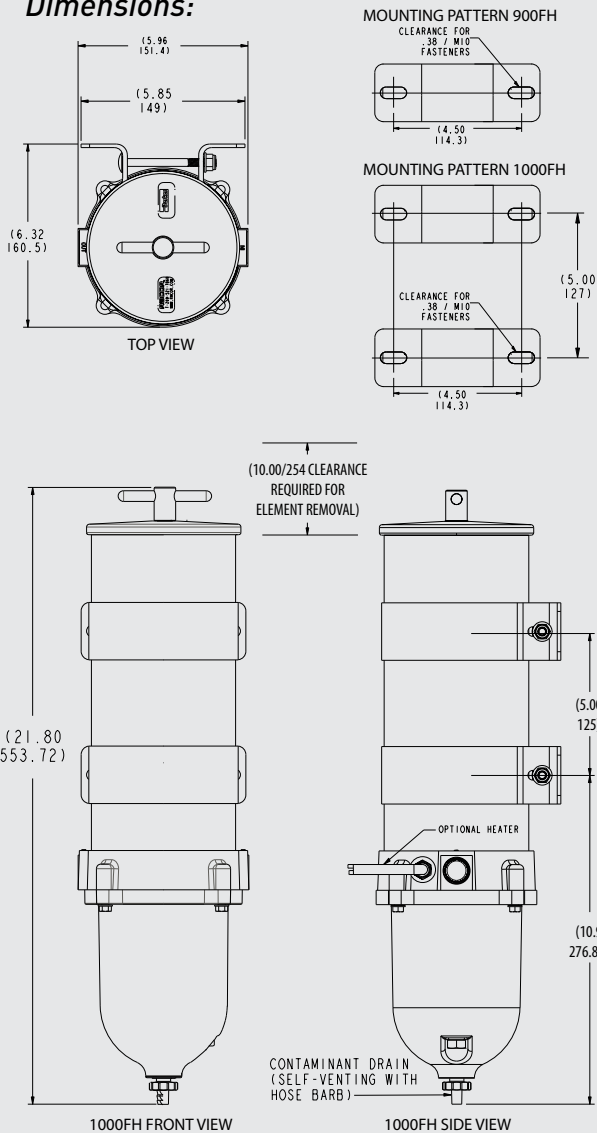

ASSEMBLY DESCRIPTION

ASSEMBLY	DESCRIPTION
900FH2	900 Turbine Assy., 2 micron Filter
900FH10	900 Turbine Assy., 10 micron Filter
900FH30	900 Turbine Assy., 30 micron Filter
900FH31230	900 Turbine Assy., 12VDC Heater, 30 micron Filter
900FH32430	900 Turbine Assy., 24VDC Heater, 30 micron Filter
1000FH2	1000 Turbine Assy., 2 micron Filter
1000FH10	1000 Turbine Assy., 10 micron Filter
1000FH30	1000 Turbine Assy., 30 micron Filter
1000FH3122	1000 Turbine Assy., 12VDC Heater, 2 micron Filter
1000FH31210	1000 Turbine Assy., 12VDC Heater, 10 micron Filter
1000FH31230	1000 Turbine Assy., 12VDC Heater, 30 micron Filter
1000FH3242	1000 Turbine Assy., 24VDC Heater, 2 micron Filter
1000FH32430	1000 Turbine Assy., 24VDC Heater, 30 micron Filter

SINGLE ASSEMBLY



WARNING: The products described in this literature can expose you to chemicals including Diisononyl phthalate, Carbon black extract, which are known to the State of California to cause cancer. For more information go to www.P65Warnings.ca.gov.

PARTS

Turbine - 900FH/1000FH

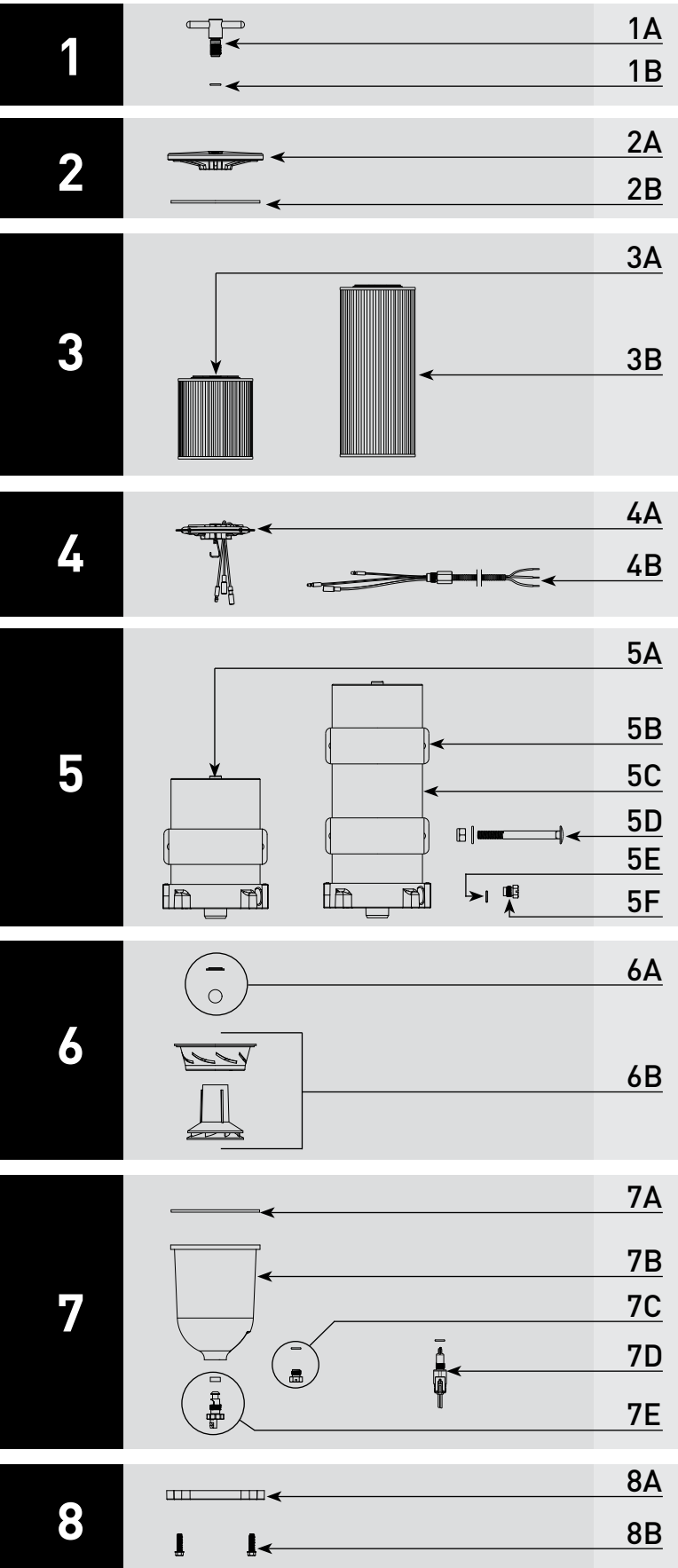

Part #		Description
1A	RK23183	T-handle Kit - Includes 1B & 2B
	RK19671	Optional - Stainless Steel T-handle Vacuum Gauge
1B		T-handle O-ring - Included in 9A
2A	RK 11-1927-01	900FH/1000FH Lid Kit - Includes 1B & 2B
2B		Lid Gasket - Included in 9A
3A	2040N-02	900FH Replacement Element 2 micron - Includes 1B & 2B
	2040N-10	900FH Replacement Element 10 micron - Includes 1B & 2B
	2040N-30	900FH Replacement Element 30 micron - Includes 1B & 2B
3B	2020N-02	1000FH Replacement Element 2 micron - Includes 1B & 2B
	2020N-10	1000FH Replacement Element 10 micron - Includes 1B & 2B
	2020N-30	1000FH Replacement Element 30 micron - Includes 1B & 2B
4A	RK11-2016	Heater Kit - 12 vdc, 325 watt - Includes 1B, 2B & 4B
	RK11-2015	Heater Kit - 24 vdc, 325 watt - Includes 1B, 2B & 4B
4B		3-wire Heater Feed-thru - Included in 4A
5A	RK11-2009	900FH Body/Housing/Return Tube - Includes 2B, 7A & 8B
5B	RK11-2005	Bracket Kit - Includes Bolt, Washer, and Nut
5C	RK11-2010	1000FH Body/Housing/Return Tube - Includes 2B, 7A & 8B
5D	RK 11838	Carriage Bolt Kit - Includes (2) Bolt, (2) Washer, and (2) Nuts
5E		Heater Feed-thru or Plug O-ring - Included in 9A
5F	RK 11-1679	Feed-thru Plug - Includes 5E
6A	RK 11028B	Checkball and Gasket Kit - Included in 9A
6B	RK 11-1939	Centrifuge and Baffle Kit - Includes 6A & 7A
7A		Bowl Gasket - Included in 9A
7B	RK 11-1938	Bowl Kit - Includes 7A, 7C & 7E
7C	RK 20126	Bowl Plug (O-ring Included in 9A)
7D	RK33802	WIF Probe Kit - 1/2"-20 UNF - Two Wire Pigtail Water Detection Module Required - Use 9C
7E		Self-venting Drain (Gasket Included in 9A)
8A	RK 11037A	Bowl Ring Kit (FH - Tan) - Includes 7A & 8B
8B	RK 11542	Cap Screw Bowl Fasteners (set of 4)

Accessories and Parts Available - *Not Shown*

9A	RK 11-1952	Complete Seal Service Kit - 900FH/1000FH Series Filters
9B	RK19669	Vacuum Gauge (30" Hg) - 3 needles: Theshold (red), Max Change Out (Red - Adjustable), Gauge (Black)
	RK19667	Compound Gauge - pressure (15 PSI) and vacuum (30" Hg)
9C	RK 14329	Water Detection Module - 12 vdc
	RK 14321	Water Detection Module - 24 vdc
9D	RK30880E	WIF Sensor/Detection Kit - 1/2"-20 UNF
9E	RK11-1978	Checkball Spring Kit
9F	RKP1912	Primer Pump Kit - 12 vdc - <i>Adds 3.25" (8.26 cm) to Height</i>
	RKP1924	Primer Pump Kit - 24 vdc - <i>Adds 3.25" (8.26 cm) to Height</i>

Turbine Series - 900/1000MA-MAM

FUEL

Specifications:

Height: 900MA: 16.2" (41.9 cm) MAM: 15.9" (41.9 cm)
1000MA: 22.0" (55.4 cm) MAM: 21.8" (55.4 cm)

Width: 5.96" (15.1 cm)

Depth: 5.96" (15.1 cm)
with Bracket 6.32" (16.1 cm)

Weight: 900MA: 6.0 lbs (2.7 kg) MAM: 7.0 lbs (3.2 kg)
1000MA: 10 lbs (4.5 kg) MAM: 11 lbs (5.0 kg)

Ports: 7/8"-14 UNF-2B (SAE J1926)

Service Clearance (Top): 900MA: 5.0" (12.7 cm)
1000MA: 10.0" (25.4 cm)

Vacuum Installation Recommended

Maximum Pressure: 15 psi (1.03 bar)

Max Flow Rate: 900MA/M: 90 gph (341 lph)
1000MA/M: 180 gph (681 lph)

Create a Part Number

Housing Type	Turbine Model - Marine 90 GPH (341 LPH) Clear Bowl/Heat Shield	Turbine Model - Marine 180 GPH (681 LPH) Clear Bowl/Heat Shield	Assembly Options	Metal Bowl Option	Probe - WIF Probe	Filtration Rating		
	900MA	1000MA					M	
		1000MA		P		2	10	30
								10

RACOR®

Dimensions:

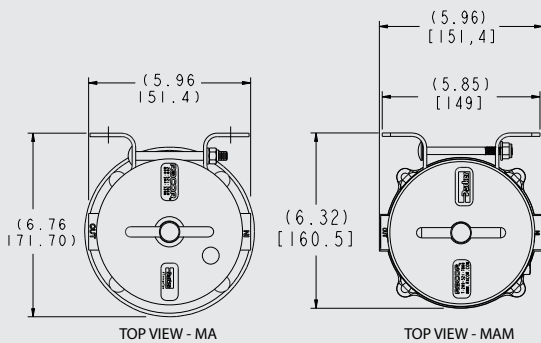

ASSEMBLY	DESCRIPTION
900MA2	900 Marine Turbine Assy., 2 micron Filter
900MA10	900 Marine Turbine Assy., 10 micron Filter
900MA30	900 Marine Turbine Assy., 30 micron Filter
900MAM2	900 Marine - Metal Bowl - Turbine Assy., 2 micron Filter
900MAM10	900 Marine - Metal Bowl - Turbine Assy., 10 micron Filter
900MAM30	900 Marine - Metal Bowl - Turbine Assy., 30 micron Filter
1000MA2	1000 Marine Turbine Assy., 2 micron Filter
1000MA10	1000 Marine Turbine Assy., 10 micron Filter
1000MA30	1000 Marine Turbine Assy., 30 micron Filter
1000MAM2	1000 Marine - Metal Bowl - Turbine Assy., 2 micron Filter
1000MAM10	1000 Marine - Metal Bowl - Turbine Assy., 10 micron Filter
1000MAM30	1000 Marine - Metal Bowl - Turbine Assy., 30 micron Filter
1000MAP10	1000 Marine - Water Probe - Turbine Assy., 10 micron Filter

SINGLE ASSEMBLY

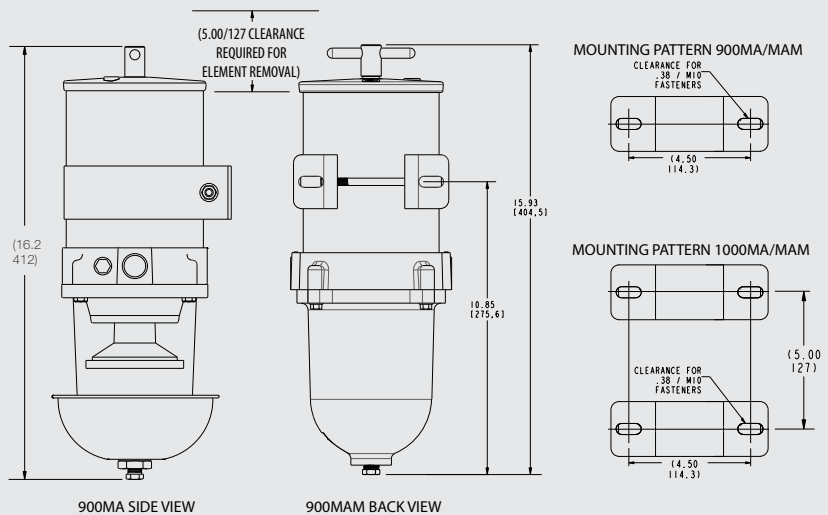
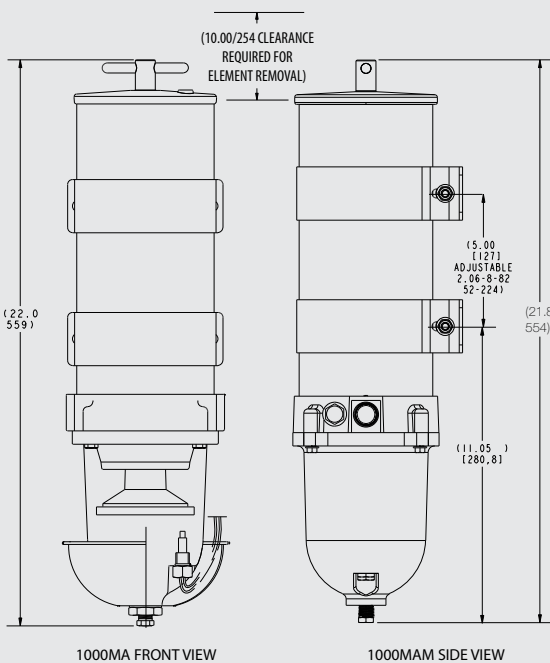

WARNING: The products described in this literature can expose you to chemicals including Diisononyl phthalate, Carbon black extract, which are known to the State of California to cause cancer. For more information go to www.P65Warnings.ca.gov.

PARTS

Turbine - 900/1000MA-MAM

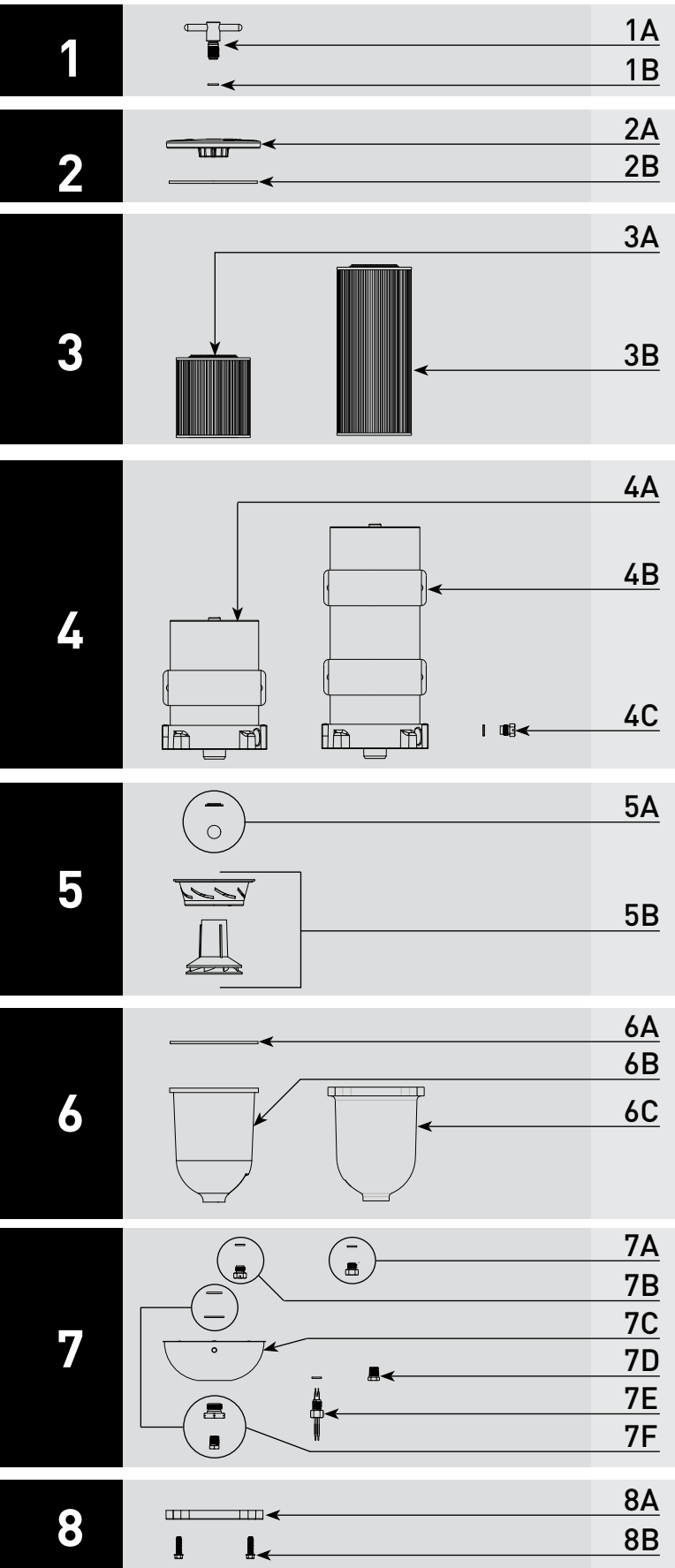

Part #		Description
1A	RK23183	Stainless Steel T-handle Kit - Includes 1B Optional - Stainless Steel T-handle Vacuum Gauge
	RK19671	
1B		T-handle O-ring - Included in 9A
2A	RK 11-1933-04	900/1000MA-MAM Lid Kit - Includes 1B & 2B
2B		Lid Gasket - Included in 9A
3A	2040N-02	900MA/MAM Replacement Element 2 micron - Includes 1B & 2B 900MA/MAM Replacement Element 10 micron - Includes 1B & 2B 900MA/MAM Replacement Element 30 micron - Includes 1B & 2B
	2040N-10	
	2040N-30	
3B	2020N-02	1000MA/MAM Replacement Element 2 micron - Includes 1B & 2B 1000MA/MAM Replacement Element 10 micron - Includes 1B & 2B 1000MA/MAM Replacement Element 30 micron - Includes 1B & 2B
	2020N-10	
	2020N-30	
4A		900/1000MA-MAM Body/Housing - Not Sold Separately
4B	RK11-2005	Bracket Kit - (Black) Includes Bolt, Washer, and Nut
4C	RK 11-1679	Plastic Feed-thru Plug Kit (O-ring Included in 9A) Metal Feed-thru Plug - Contact Technical Support
5A	RK 11028B	Checkball and Gasket Kit (Gasket Included in 9A)
5B	RK 11-1939	Centrifuge and Baffle Kit - Includes 5A & 6A
6A		Bowl Gasket - Included in 9A
6B	RK 11-1606-1	MA Bowl Kit (Clear) - Includes 6A, 7B & 7F (Gasket & O-ring only)
6C	RK 11734-03	MAM Bowl Kit (Metal) - Includes 6A, 7A, 7D and 8B
7A	RK 20022	Metal Bowl Plug Kit (MAM) (O-ring Included in 9A)
7B	RK 20126	Plastic Bowl Plug Kit (MA) (O-ring Included in 9A)
7C	RK 11868	Heat Deflector Kit (MA) - Includes 7F
7D		Drain Plug (MAM) - Contact Technical Support
7E	RK 21069	WIF Probe - 1/2"-20 UNF - 2-wire (MA) - Requires 9C WIF Probe - Stainless Steel - 1/2"-20 UNF - 2-wire (MAM) - Requires 9C
	RK23191	
7F	RK 11-1910	Drain Plug Kit (MA) (Gasket & O-ring Included in 9A)
8A	RK 11037A-01	Bowl Ring Kit (For MA Only - White) - Includes 6A & 8B
8B	RK 11542	Cap Screw Bowl Ring Fasteners (set of 4)

Accessories and Parts Available - Not Shown

9A	RK 11-1404	Complete Seal Service Kit - 900/1000 Series Filters
9B	RK19669	Vacuum Gauge (30" Hg) - 3 needles: Theshold (red), Max Change Out (Red - Adjustable), Gauge (Black) Compound Gauge - pressure (15 PSI) and vacuum (30" Hg)
	RK19667	
9C	RK 14329	Water Detection Module - 12 vdc Water Detection Module - 24 vdc
	RK 14321	
9D	RK11-1978	Checkball Spring Kit
9E	RKP1912	Primer Pump Kit - 12 vdc - Adds 3.25" (8.26 cm) to Height Primer Pump Kit - 24 vdc - Adds 3.25" (8.26 cm) to Height
	RKP1924	

Model
MA



Model
MAM



Turbine Series - 75900/1000FHX

FUEL

Specifications:

Diesel Applications

Height: 75900FHX: 16.5" (41.9 cm)
751000FHX: 21.8" (55.4 cm)

Width: 18.75" (47.6 cm) with Bracket

Depth: 10.8" (27.4 cm) with Bracket

Dry Weight: 75900FHX: 23.0 lbs (10.4 kg)
751000FHX: 30 lbs (13.6 kg)

Valve Male Fittings:
7/8"-14 UNF-2A (SAE J514 37° Flare)

Service Clearance (Top):
75900FHX: 5.0" (12.7 cm)
751000FHX: 10.0" (25.4 cm)

Vacuum Installation Recommended
Maximum Head Pressure: 15 psi (1.03 bar)

Max Flow Rate:
75900FHX: 180 gph (682 lph)
751000FHX: 360 gph (1362 lph)

Create a Part Number

Housing Type	Filter Model	Valve Type	Filtration Rating
Dual Assembly	Turbine Model 90/180 GPH Flow Rate	6-Port Ball Valve	2 micron
75	Turbine Model 180/360 GPH Flow Rate	X	10 micron
	900FH 1000FH		30 micron

RACOR®

Dimensions:

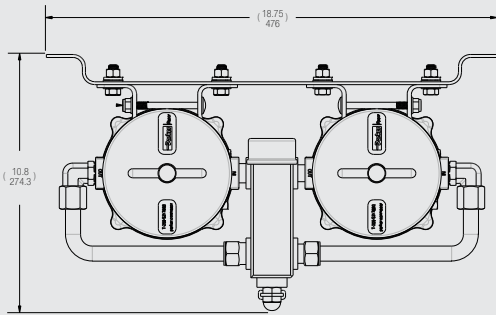

75900FHX/751000FHX Top

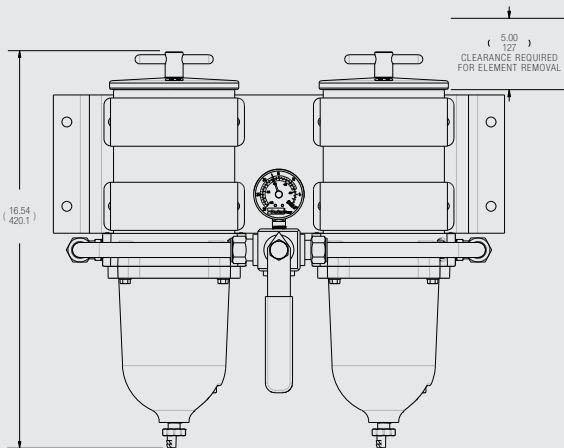

75900FHX Front

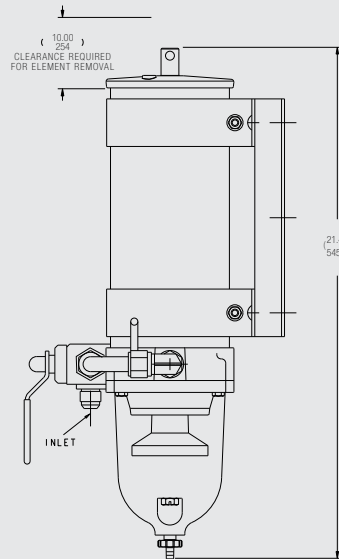

751000FHX Profile

ASSEMBLY	DESCRIPTION
75900FHX2	Dual 900 Turbine Assy., 2 micron Filter
75900FHX10	Dual 900 Turbine Assy., 10 micron Filter
75900FHX30	Dual 900 Turbine Assy., 30 micron Filter
751000FHX2	Dual 1000 Turbine Assy., 2 micron Filter
751000FHX10	Dual 1000 Turbine Assy., 10 micron Filter
751000FHX30	Dual 1000 Turbine Assy., 30 micron Filter

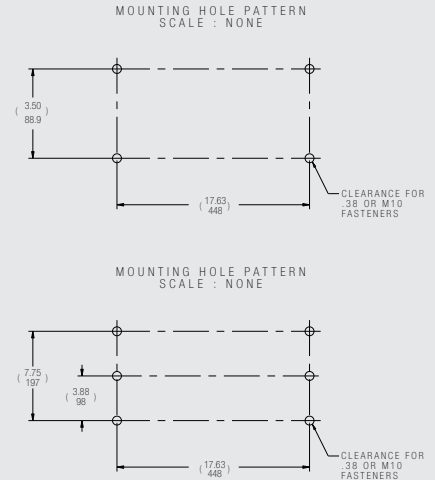

DUAL ASSEMBLIES



PARTS

Turbine Series - 75900/1000FHX

1

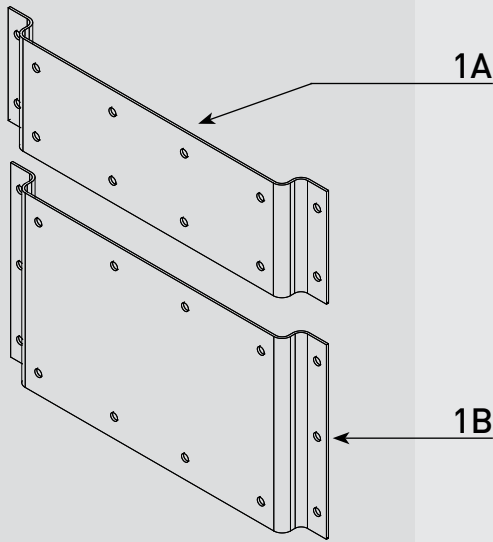

2

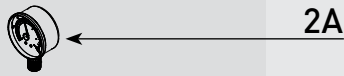

3

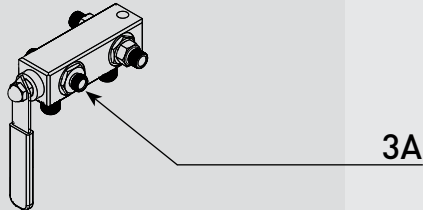

4

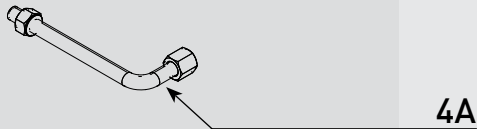

5

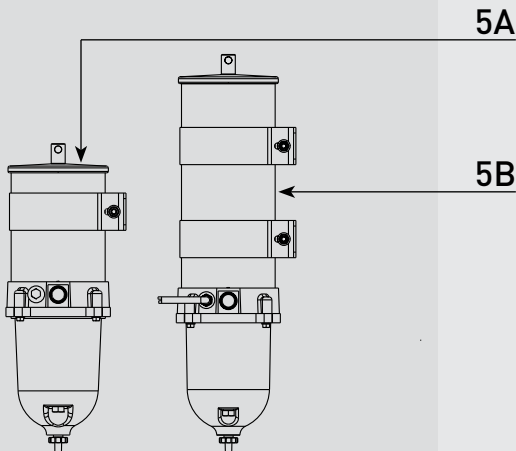

See **RSL0292**
For 900FH/1000FH Parts Breakdown

Part #	Description
1A	Mounting Bracket - 75900FHX - Bracket only
1B	Mounting Bracket - 751000FHX - Bracket only
2A	RK19669 Vacuum Gauge (30" Hg) - 3 needles: Theshold (red), Max Change Out (Red - Adjustable), Gauge (Black) RK19667 <i>Optional</i> - Compound Gauge Kit (Vacuum 30" HG / Pressure 15psi)
3A	RK 19473 6-Port Ball Valve RK 19506 Valve Service Kit - Includes Handle/Stem/O-rings/Gasket
4A	RK 19475 Rigid Tubing Kit - Includes (1ea.) Tube, Ferrule and Fitting
5A	Turbine Fuel Filter - 900FH Series See Cutsheet RSL0292 for available Parts and Accessories
5B	Turbine Fuel Filter - 1000FH Series See Cutsheet RSL0292 for available Parts and Accessories

Accessories and Parts Available (Not Shown)

6A	RK 11-1952 Complete Seal Service Kit - 900FH/1000FH Series Filters (Requires 2) RK 11-1404 Complete Seal Service Kit - 900/1000 Series Filters For FG and Older Models (Requires 2)
6B	RK30880E WIF Sensor and Light Kit - 1/2"-20 UNF
6C	RK 14329 Water Detection Module - 12 vdc RK 14321 Water Detection Module - 24 vdc
7A	Bowl Gasket - Included in 6A
7B	RK 11-1938 Bowl Kit - Includes 7A, 7C & 7E
7C	RK 20126 Bowl Plug (O-ring Included in 6A)
7D	RK33802 WIF Probe Kit - 1/2"-20 UNF - Two Wire Pigtail Water Detection Module Required - Use 6C
7E	Self-venting Drain (O-ring Included in 6A)
8A	2040V2 900FH Replacement Element 2 micron 2040V10 900FH Replacement Element 10 micron 2040V30 900FH Replacement Element 30 micron
8B	2020V2 1000FH Replacement Element 2 micron 2020V10 1000FH Replacement Element 10 micron 2020V30 1000FH Replacement Element 30 micron

Valve Operations

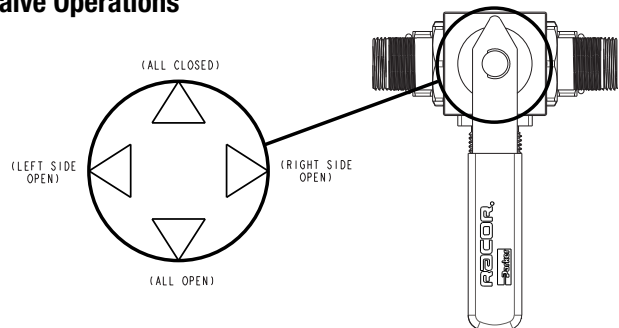

Turbine Series - 75900/1000MAX/M/P

FUEL

Specifications:

Diesel Applications

Height: 75900MAX: 16.5" (41.9 cm)
 751000MAX: 22.0" (55.9 cm)
 75900MAXM: 15.8" (40.1 cm)
 751000MAXM: 21.8" (55.4 cm)

Width: 18.75" (47.6 cm) with Bracket

Depth: 10.8" (27.4 cm) with Bracket

Weight: 75900MAX: 23.0 lbs (10.4 kg)
 751000MAX: 30 lbs (13.6 kg)
 75900MAXM: 23.0 lbs (10.4 kg)
 751000MAXM: 30 lbs (13.6 kg)

Valve Male Fittings:
 7/8"-14 UNF-2A
 (SAE J514 37° Flare)

Service Clearance (Top):
 75900MAX: 5.0" (12.7 cm)
 751000MAX: 10.0" (25.4 cm)

Vacuum Installation Recommended
Maximum Head Pressure: 15 psi (1.03 bar)

Max Flow Rate:
 75900MAX: 180 gph (682 lph)
 751000MAX: 360 gph (1362 lph)

Create a Part Number

Housing Type	Dual Assembly	Filter Model		Valve Type	Assembly Options	Filtration Rating
	75	Turbine Model 90/180 GPH Flow Rate	Turbine Model 180/360 GPH Flow Rate			
		900MA	1000MA	X	M P	2 10 30

* Probe option available on 751000MAXP10 only.

Dimensions:

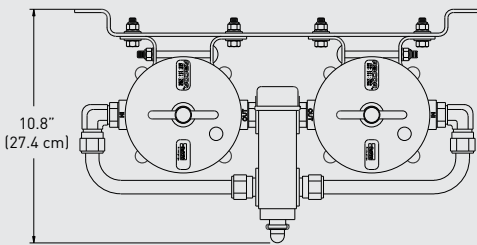

75900MAX/751000MAX Top

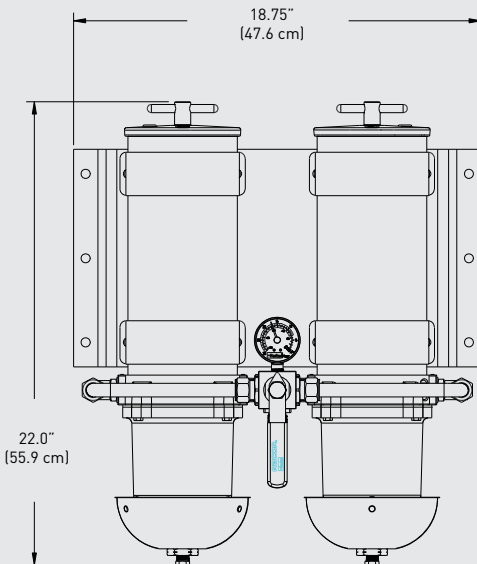

751000MAX Front

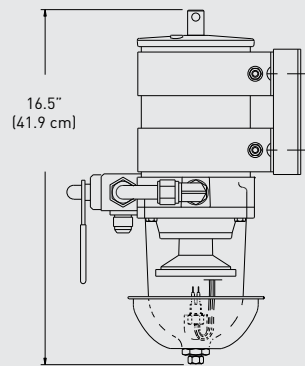

75900MAXP Profile

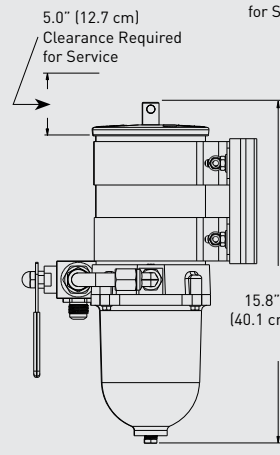

75900MAXM Profile

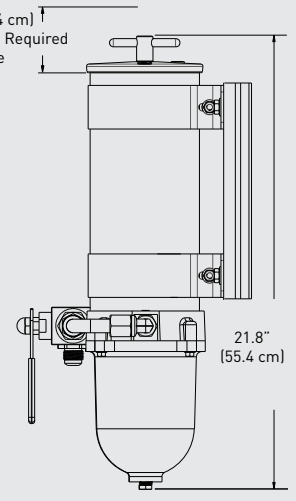

751000MAXM Profile

ASSEMBLY	DESCRIPTION
75900MAX2	Marine - Dual 900 Turbine Assy., 2 micron Filter
75900MAX10	Marine - Dual 900 Turbine Assy., 10 micron Filter
75900MAX30	Marine - Dual Turbine Assy., 30 micron Filter
751000MAX2	Marine - Dual 1000 Turbine Assy., 2 micron Filter
751000MAX10	Marine - Dual 1000 Turbine Assy., 10 micron Filter
751000MAX30	Marine - Dual 1000 Turbine Assy., 30 micron Filter
75900MAXM2	Marine - Metal Bowl - Dual 900 Turbine Assy., 2 micron Filter
75900MAXM10	Marine - Metal Bowl - Dual 900 Turbine Assy., 10 micron Filter
75900MAXM30	Marine - Metal Bowl - Dual 900 Turbine Assy., 30 micron Filter
751000MAXM2	Marine - Metal Bowl - Dual 1000 Turbine Assy., 2 micron Filter
751000MAXM10	Marine - Metal Bowl - Dual 1000 Turbine Assy., 10 micron Filter
751000MAXM30	Marine - Metal Bowl - Dual 1000 Turbine Assy., 30 micron Filter
751000MAXP10	Marine - Dual 1000 Turbine Assy., Water Sensor Probe, 10 micron Filter



RACOR®

DUAL ASSEMBLIES

PARTS

Turbine Series - 75900/1000MAX/M/P

1

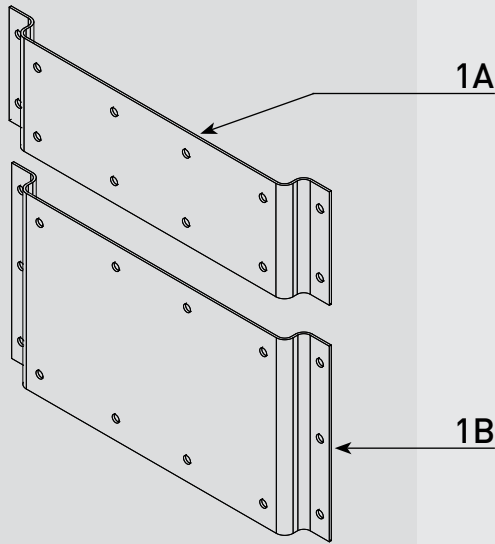

Part #	Description
1A	Mounting Bracket - 75900MAX - Bracket only (Beige Color)
1B	Mounting Bracket - 751000MAX - Bracket only (Beige Color)
2A	RK19669 Vacuum Gauge (30" Hg) - 3 needles: Theshold (red), Max Change Out (Red - Adjustable), Gauge (Black) RK19667 <i>Optional</i> - Compound Gauge Kit (Vacuum 30" HG / Pressure 15psi)
3A	RK 19473 6-Port Ball Valve RK 19506 Valve Service Kit - Includes Handle/Stem/O-rings/Gasket
4A	RK 19475 Rigid Tubing Kit - Includes (1ea.) Tube, Ferrule and Fitting
5A	Turbine Fuel Filter - 900MA Series See Cutsheet RSL0293 for available Parts and Accessories
5B	Turbine Fuel Filter - 1000MA Series See Cutsheet RSL0293 for available Parts and Accessories

2

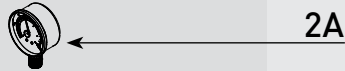

Accessories and Parts Available (Not Shown)

6A	RK 11-1952	Complete Seal Service Kit - 900MA/1000MA Series Filters (<i>Requires 2</i>)
6B	RK 21069 RK23191	WIF Probe (pig tail) - 1/2"-20 UNF - Requires 6C WIF Probe (Steel/pig tail) - 1/2"-20 UNF - Requires 6C
6C	RK 14329 RK 14321	Water Detection Module - 12 vdc Water Detection Module - 24 vdc

3

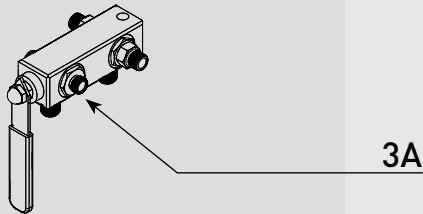

7A		Bowl Gasket - Included in 6A
7B	RK 11-1606-1	MA Bowl Kit (Clear) - Includes 7A, 7E & 7H (Gasket & O-ring only)
7C	RK 11734-03	MAM Bowl Kit (Metal) - Includes 7A, 7D & 7G
7D	RK 20022	Metal Bowl Plug Kit (MAM) (O-ring Included in 6A)
7E	RK 20126	Plastic Bowl Plug Kit (MA) (O-ring Included in 6A)
7F	RK 11868	Heat Deflector Kit (MA) - Includes 7H
7G		Drain Plug (MAM) - <i>Contact Technical Support</i>
7H	RK 11-1910	Drain Plug Kit (MA) (Gasket & O-ring Included in 6A)

4

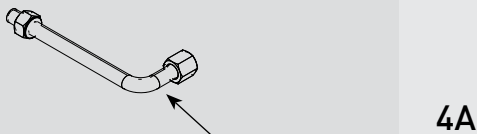

8A	2040V2 2040V10 2040V30	900MA/MAM Replacement Element 2 micron 900MA/MAM Replacement Element 10 micron 900MA/MAM Replacement Element 30 micron
8B	2020V2 2020V10 2020V30	1000MA/MAM Replacement Element 2 micron 1000MA/MAM Replacement Element 10 micron 1000MA/MAM Replacement Element 30 micron

5

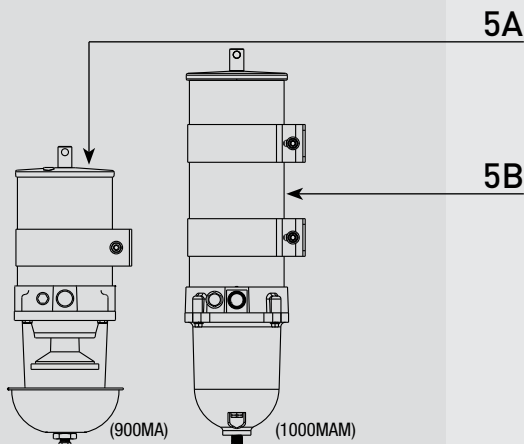

See **RSL0293**
For 900MA/1000MA Parts Breakdown

Valve Operations

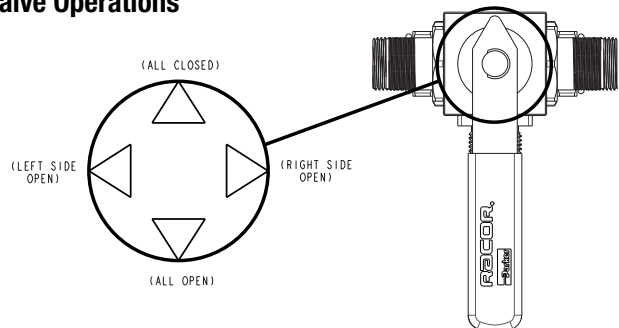

Turbine Series - 791000MAV-MAVM

FUEL

Specifications:

Height: MAV - 21.32" (54.15 cm)
 MAVM - 20.9" (53.1 cm)

Width: 21.5" (54.6 cm) with Bracket

Depth: 11.7" (29.7 cm) with Bracket

Weight: MAV - 52.0 lbs (22.2 kg)
 MAVM - 55.0 lbs (24.0 kg)

Ports: 3/4"-14 NPT

Service Clearance (Top): 10.0" (25.4 cm)

Vacuum Installation Recommended
Maximum Pressure: 15 psi (1.03 bar)

Max Flow Rate: 540 gph (2044 lph)

Create a Part Number

Assembly Type	Filter Model	Model Type	Metal Bowl Option	Filtration Rating
Triple Assembly - Valves 180/360/540 gph Flow Rate	Turbine Model - Marine 180 gph Flow Rate (X3)	Valves	Metal Bowl	2 micron 10 micron 30 micron
79	1000MA	V	M	2 10 30

RACOR®

ASSEMBLY	DESCRIPTION
791000MAV2, 791000MAV10, 791000MAV30	Triple Manifold 1000 Turbine Assy., 2, 10, or 30 micron Filter
791000MAVM2, 791000MAVM10, 791000MAVM30	Triple Manifold 1000 Turbine Assy., Metal Bowl, 2, 10, or 30 micron Filter

Dimensions:

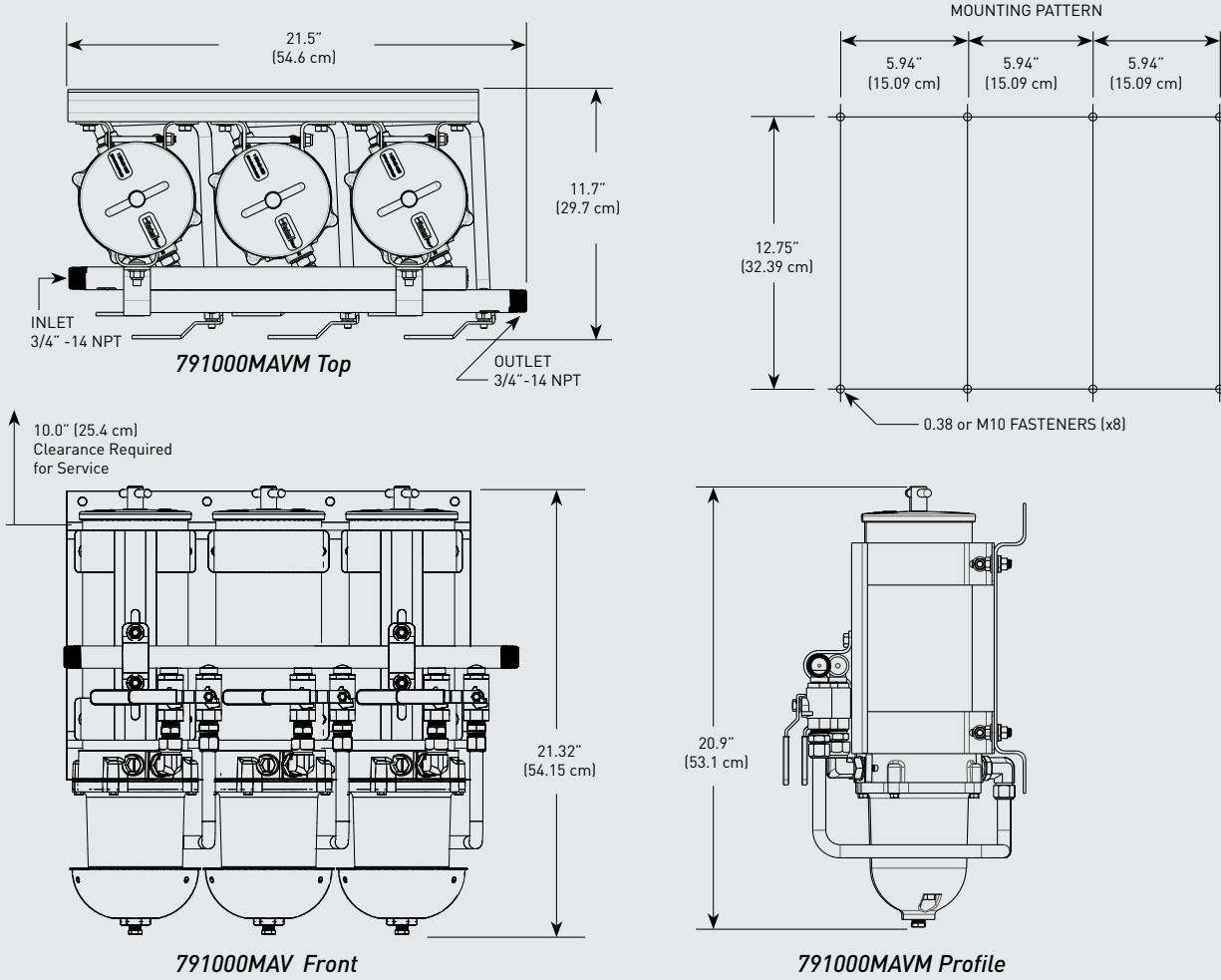

WARNING: The products described in this literature can expose you to chemicals including Diisononyl phthalate, Carbon black extract, which are known to the State of California to cause cancer. For more information go to www.P65Warnings.ca.gov.

TRIPLE ASSEMBLIES

PARTS

Turbine Series - 791000MAV-MAVM

1

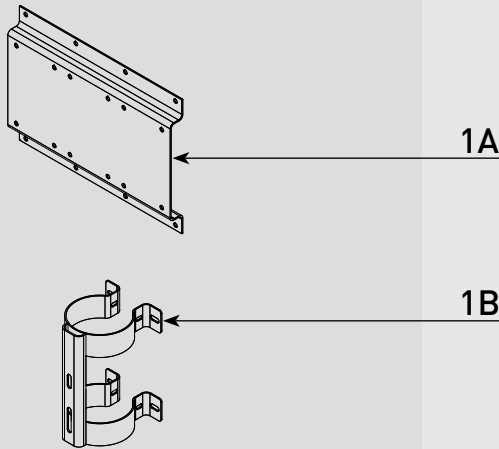

2

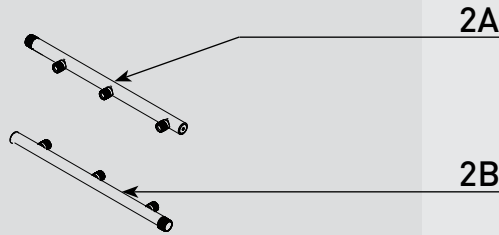

3



4

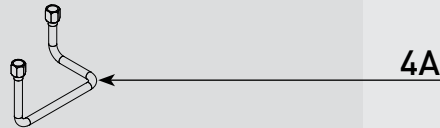

5

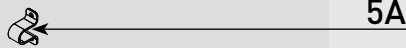

6

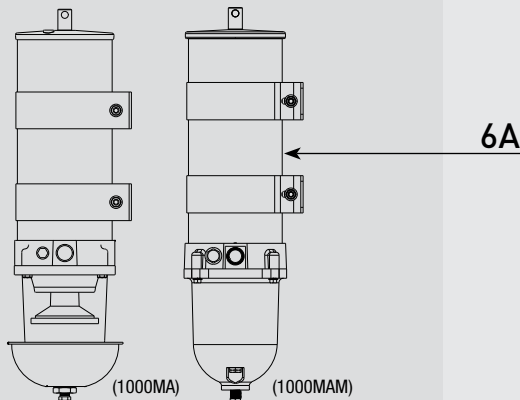

See **RSL0293**
For 1000MA/MAM Parts Breakdown

Part #	Description
1A	Main Mounting Bracket - <i>Contact Technical Support</i>
1B	Manifold Assembly Bracket - <i>Contact Technical Support</i>
2A	19460 Inlet Manifold Tube (3/4"-14 NPT) - (Tan)
2B	19461 Outlet Manifold Tube (3/4"-14 NPT) - (Tan)
3A	RK 11073 Ball Valve Assembly (<i>uses 6</i>)
4A	Manifold tube - <i>Contact Technical Support</i>
5A	11-1761 U-bracket (<i>uses 2</i>)
6A	Turbine Fuel Filter - 1000MA/MAM Series (<i>Uses 3</i>) See Cutsheet RSL0293 for available Parts and Accessories

Accessories and Parts Available (*Not Shown*)

7A	RK 11-1404	Complete Seal Service Kit - 1000MA/MAM Series Filters (<i>Requires 3</i>)
7B	RK 21069 RK23191	WIF Probe - 1/2"-20 UNF - 2-wire (MA) - Requires 7C * WIF Probe - Stainless Steel - 1/2"-20 UNF - 2-wire (MAM) - Requires 7C *
7C	RK 14329 RK 14321	Water Detection Module - 12 vdc Water Detection Module - 24 vdc
8A		Bowl Gasket - Included in 7A
8B	RK 11-1606-1	MA Bowl Kit (Clear) - Includes 8A, 9B & 9F (Gasket & O-ring only)
8C	RK 11734-03	MAM Bowl Kit (Metal) - Includes 8A, 9A, 9D and 10B
9A	RK 20022	Metal Bowl Plug Kit (MAM) (O-ring Included in 7A)
9B	RK 20126	Plastic Bowl Plug Kit (MA) (O-ring Included in 7A)
9C	RK 11868	Heat Deflector Kit (MA) - Includes 9F
9D		Drain Plug (MAM) - <i>Contact Technical Support</i>
9E	RK 11-1910	Drain Plug Kit (MA) (Gasket & O-ring Included in 7A)
10A	RK 11037A-01	Bowl Ring Kit (For MA Only - White) - Includes 8A & 10B
10B	RK 11542	Cap Screw Bowl Ring Fasteners (set of 4)
11A	2020N-02 2020N-10 2020N-30	1000MA/MAM Replacement Element 2 micron (<i>uses 3</i>) 1000MA/MAM Replacement Element 10 micron (<i>uses 3</i>) 1000MA/MAM Replacement Element 30 micron (<i>uses 3</i>)

* Note: If all 3 units are used simultaneously, one probe or sensor can be used. If units are used as backups, then a probe or sensor should be installed in each bowl. Multiple probes can be wired in parallel to a single detection module.

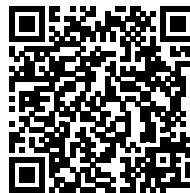

Online Link
Turbine Series Selector



Online Link
Turbine Series
Replacement Parts Selector